

Replacement Parts

for 12" Polycarbonate Pedestrian and Lane Control Signals

Ordering Information

12" (300mm) Polycarbonate Ped and Lane Control Sign Parts

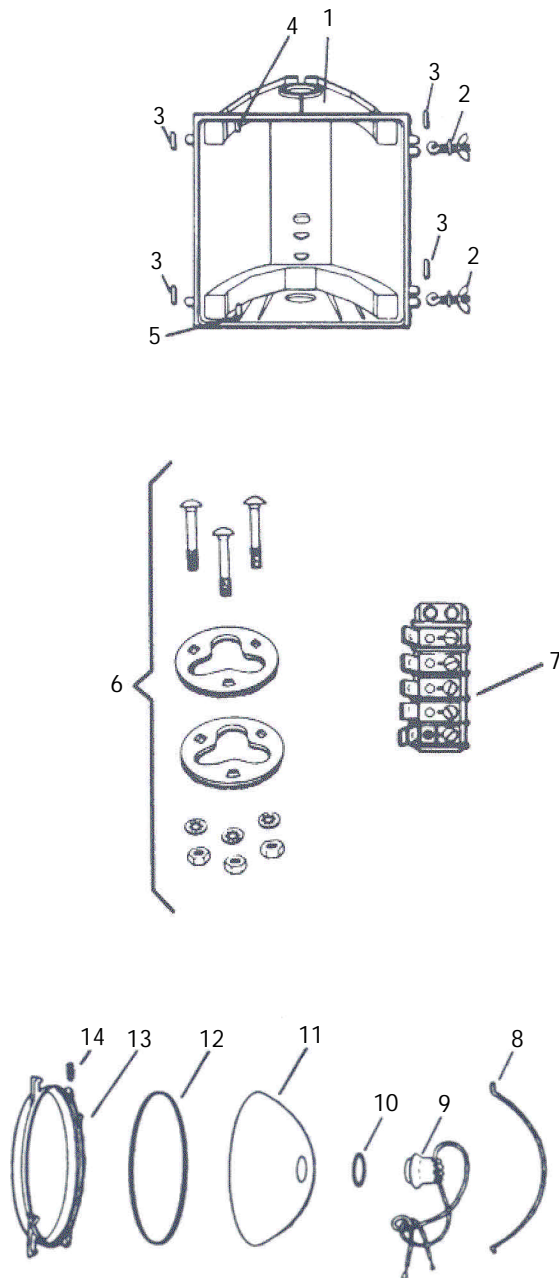

Item	Part Description	Catalog Number
1	Body*.....	0700431
2	Eye bolt, wing nut, and washer assembly	TL4119
3	3/16" x 1" groove pin for eye bolt and door	0700478
4	Groove pin, top.....	11CO2-018D24
5	Groove pin, bottom.....	11CO2-018D12
6	Bolt assembly for connecting sections.....	0700127
7	Terminal block, 5 position	20U30-005
8	Spring wire bail.....	0700012
9	Receptacle and lead assembly, black and white wires	0700620B
	Receptacle and lead assembly, red and white wires	0700620R
	Receptacle and lead assembly, yellow and white wires.....	0700620Y
	Receptacle and lead assembly, green and white wires.....	0700620G
10	Receptacle gasket.....	13B12-1395
11	Alzak® aluminum reflector assembly.....	0700004
12	Reflector gasket.....	013G51-1399
13	Reflector retaining ring	0700455
14	Reflector spring	0700013

* Standard colors are Dark Green and Federal Yellow. Please specify color on the order.

Ordering Information

Additional Parts for 12" (300mm) Ped & Lane Control Signals

Item	Part Description	Catalog Number
15	Door Assembly*	0700590
16	Door gasket	0700477-12
17	Lens	See Visors & Lenses sheet for listing
18	Lens gasket.....	0700286
19	Lens clip	0700014
20	Lens clip screw	10A08-019D08
21	Visor.....	See Visors & Lenses sheet for listing
22	Visor screw.....	10H26-013D12

* Standard colors are Dark Green and Federal Yellow.
Please specify color on the order.

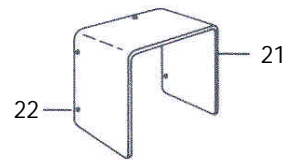
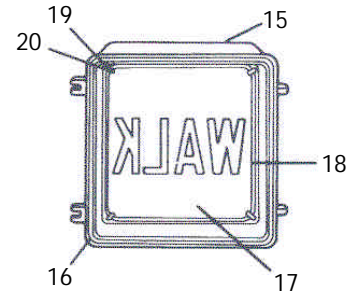

Making the World a Safer Place to Travel™

<http://www.peek-traffic.com>

Please contact Peek Traffic Corporation for customer inquiries about any of the company's Traffic Control, Data Collection, Enforcement, Detection, or Tolling products. To learn how Peek Traffic is making the world a safer place to travel, visit the Peek Traffic web site at <http://www.peek-traffic.com>.

The information contained in this publication is presented for informational purposes only, and while every effort has been made to ensure its accuracy, the information is not to be construed as warranties or guarantees, express or implied, regarding the products or services described herein or their use or applicability. No license is granted by implication or otherwise to any of Peek Traffic's intellectual property. Peek Traffic reserves the right to alter or revise any of its products or published technical data relating thereto at any time without notice.

Copyright © 2004 Peek Traffic Corporation, A Quixote Company. All rights reserved. Printed in the United States.

Peek Traffic Corporation

A Quixote Company
2511 Corporate Way
Palmetto, Florida 34221
phone: (941) 845-1200
toll free in the US: 1 (866) 260-7335
fax: 1 (941) 365-0837